



27 CARDIFF STREET, ABERDARE, CF44 7DP

TEL: 01685 878000 FAX: 01685 878000



Gladstone Street

Aberdare, CF44 6SB

£169,995



Situated on Gladstone Street in the charming town of Aberaman, this delightful mid-terrace house presents an ideal opportunity for families seeking a spacious and modern living environment. The property boasts a generous reception room that welcomes you with warmth and comfort.

The heart of the home is undoubtedly the beautiful modern kitchen diner, which offers ample space for family meals and gatherings. This well-designed area is not only functional but also stylish, making it a wonderful place to create lasting memories.

With three well-proportioned bedrooms, this home provides plenty of room for family members or guests. Each bedroom is designed to be a peaceful retreat, ensuring restful nights and rejuvenating mornings. The property also features a conveniently located bathroom, catering to the needs of a busy household. Additionally, the attic space offers further potential.

The low maintenance garden is a fantastic feature, providing a private outdoor space for children to play or for adults to unwind without the burden of extensive upkeep.



Entrance Hall

UPVC front door. Tiled floor. Radiator.

Living Room 20'09 x 10'10 (6.32m x 3.30m)

UPVC double glazed window to front. Radiatorx2. Storage.

Kitchen/Diner 15'08 x 10'11 (4.78m x 3.33m)

UPVC double glazed patio doors to rear and lantern. Radiator. Integrated oven and gas hob. Provisions for washer/dryer/fridge/freezer.

Bathroom 8'11 x 8'07 (2.72m x 2.62m)

UPVC double glazed window to rear. Radiator. Bath. Separate shower. W.C. Vanity handwash basin.

Landing

W.C.

Upstairs W.C.

Bedroom 1 13'04 x 10'11 (4.06m x 3.33m)

UPVC double glazed window to front x2. Radiator.

Bedroom 2 13'10 x 8'10 (4.22m x 2.69m)

UPVC double glazed window to rear. Radiator.

Bedroom 3 9'08 x 9'08 (2.95m x 2.95m)

UPVC double glazed window to rear. Radiator.

Attic Room 11'10 x 3'07 (3.61m x 1.09m)

Skylight x2. Radiator. Storage.

Outside

Garage with power, light and roller shutter. Patio and artificial grass.

Disclaimer

N.B Whilst these particulars are intended to give a fair description of the property concerned, their accuracy is not guaranteed and any intending purchaser must satisfy himself by inspection or otherwise, as to the correctness of statements contained herein.

The particulars do not constitute an offer or contract, and statements herein are made without responsibility, or warranty on the part of the Vendor or Manning Estate Agents, neither of whom can hold themselves responsible for expenses incurred should the property no longer be available. Items shown in photographs are NOT included unless specifically mentioned in particulars. They may however be available by separate negotiation.

The Property Misdescription Act 1991

The Agent has not tested any apparatus, equipment, fixtures and fittings or services and so cannot verify that they are in working order or fit for the purpose. A buyer is advised to obtain verification from their Solicitor or Surveyor. References to the Tenure of the property are based on information supplied by the seller. The Agent has not sight of the title documents. A Buyer is advised to obtain verification from their Solicitor.

You may download, store and use the material for your own personal use and research. You may not republish, retransmit, redistribute or otherwise make the material available to any party or make the same available on any website

These particulars, whilst believed to be accurate are set out as a general outline only for guidance and do not constitute any part of an offer or contract. Intending purchasers should not rely on them as statements of representation of fact, but must satisfy themselves by inspection or otherwise as to their accuracy. No person in this firms employment has the authority to make or give any representation or warranty in respect of the property.

27 Cardiff Street, Aberdare, CF44 7DP

Tel: 01685 878000 Email: info@manningestateagents.co.uk <https://www.manningestateagents.co.uk>

Area Map



Floor Plans

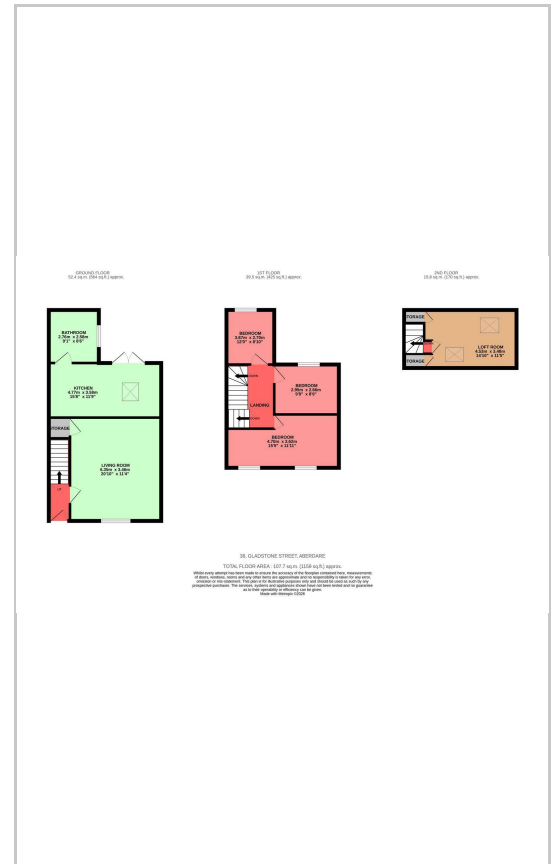

Energy Efficiency Graph

